



MAJESTIC
@ KIARA RESERVE
— PARK HOMES —



ABOVE ALL ELSE

Introducing Majestic @ Kiara Reserve, where refined luxury intertwines with the understated elegance of modern British design. Set against the serene backdrop of Bukit Kiara's Forest Reserve, this architectural masterpiece offers contemporary elegance just moments from Mont Kiara.

Here, every moment is above all else.





WAKE UP TO YOUR OWN

NATURE SANCTUARY



At Majestic @ Kiara Reserve, indulge in a lifestyle where urban sophistication meets nature's elegance. Positioned next to the pristine 400-acre Bukit Kiara Forest Reserve, you'll experience the finest blend of modern city conveniences with the serene allure of untouched greenery. Breathe in the fresh air and enjoy the luxury of seamless access to a vibrant city life, all in one exclusive address.

GARDEN RESIDENCES

PARK HOMES

Welcome to Park Homes, a limited collection of 57 elegantly designed residences set against the backdrop of the Bukit Kiara Forest Reserve. These freehold homes feature expansive open-plan layouts, perfectly suited for the needs of growing families. Surrounded by natural serenity, Park Homes offers a harmonious blend of modern living and nature's tranquillity, creating an ideal environment to nurture your family.



Perspective of Park Homes Unit



Every home is a masterclass in spatial elegance, thoughtfully curated to offer a lifestyle that rises above the ordinary, with unparalleled exclusivity in one of KL's most coveted locations.

Here, city life meets tranquil retreat – just moments from Mont Kiara.

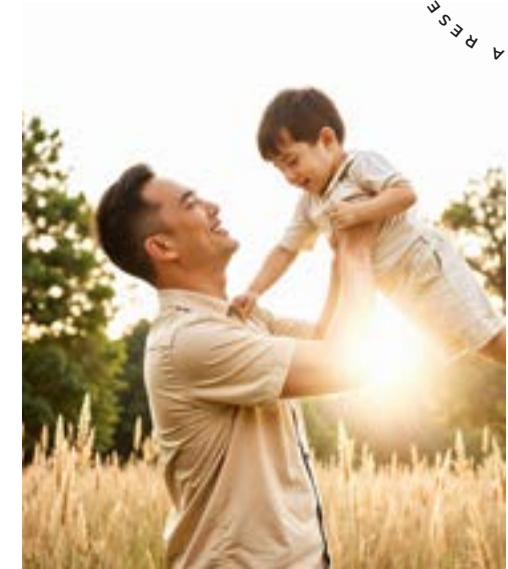



Park Homes Unit Parking Space



YOUR JOURNEY HOME

BEGINS AT THE DOORSTEP

Experience the ease and elegance of the 'Park & Live' lifestyle at our Park Homes. With ample space for three cars, including an EV charging port, each space is designed with flexibility and modern needs in mind. Here, every detail – from accessible parking to lush Bukit Kiara surroundings – is designed to create a seamless flow between your vehicle and the comforts of home, making daily living effortlessly luxurious.



THE LUXURY OF
P R I V A C Y



Artist's impression only.



Artist's impression only.

THE WARMTH OF

S U N L I G H T

Morning light fills each bedroom, creating a peaceful and inviting space that balances beauty with function. Designed for both comfort and privacy, every bedroom includes an ensuite bathroom, allowing you to start and end each day with ease and tranquillity. This thoughtful design transforms your personal space into a private haven, where relaxation is an everyday luxury.



AN EVERYDAY ESCAPE

INTO NATURE

The LG4 unit offers a unique lifestyle, with direct access to a private garden pathway and jogging trail. Surrounded by lush greenery, this connection to nature creates a tranquil extension of your living space. From morning exercise to quiet moments in the fresh air, the garden sanctuary becomes an integral part of everyday life, just steps from your door.





MAJESTIC
KUALA LUMPUR
Clubhouse

A CLUBHOUSE RETREAT

CRAFTED FOR YOU

Nestled amidst lush greenery, this exclusive residents-only clubhouse offers an array of facilities fit for relaxation and recreation. With a serene pool, a fully equipped gym, a fun playground for the little ones, beautifully landscaped gardens and more, this clubhouse is designed to foster community and connection.



Infinity Pool (LG2)



Majestic Clubhouse Overview

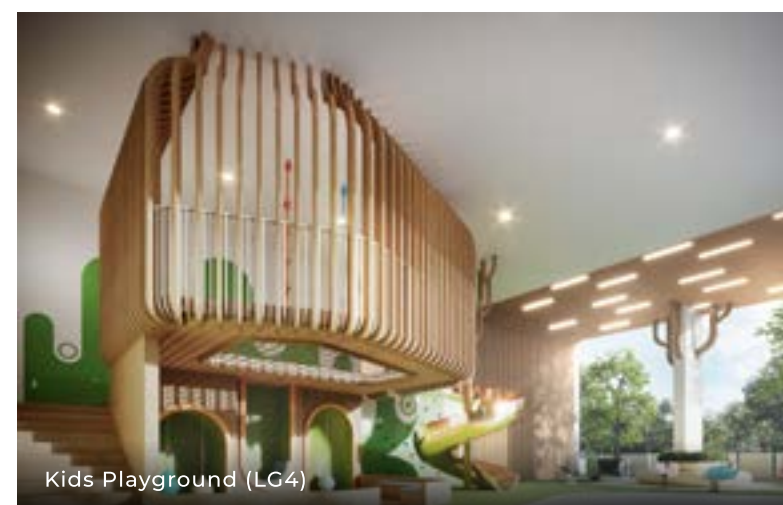

Kids Playground (LG4)

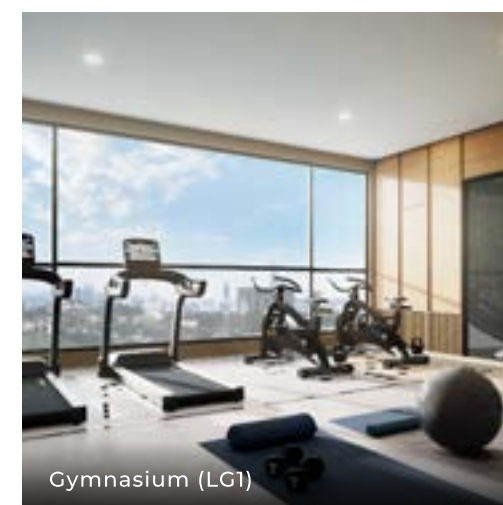

Gymnasium (LG1)



Majestic Clubhouse Lounge (G)

CROSS-SECTION

Every level of Park Homes is designed with intention – balancing privacy, functionality and a seamless connection to nature. Expansive windows invite natural light while strategic layouts ensure an open, airy feel throughout. With direct access to landscaped gardens and jogging paths, these homes offer the tranquility of landed living within a modern low-rise setting.

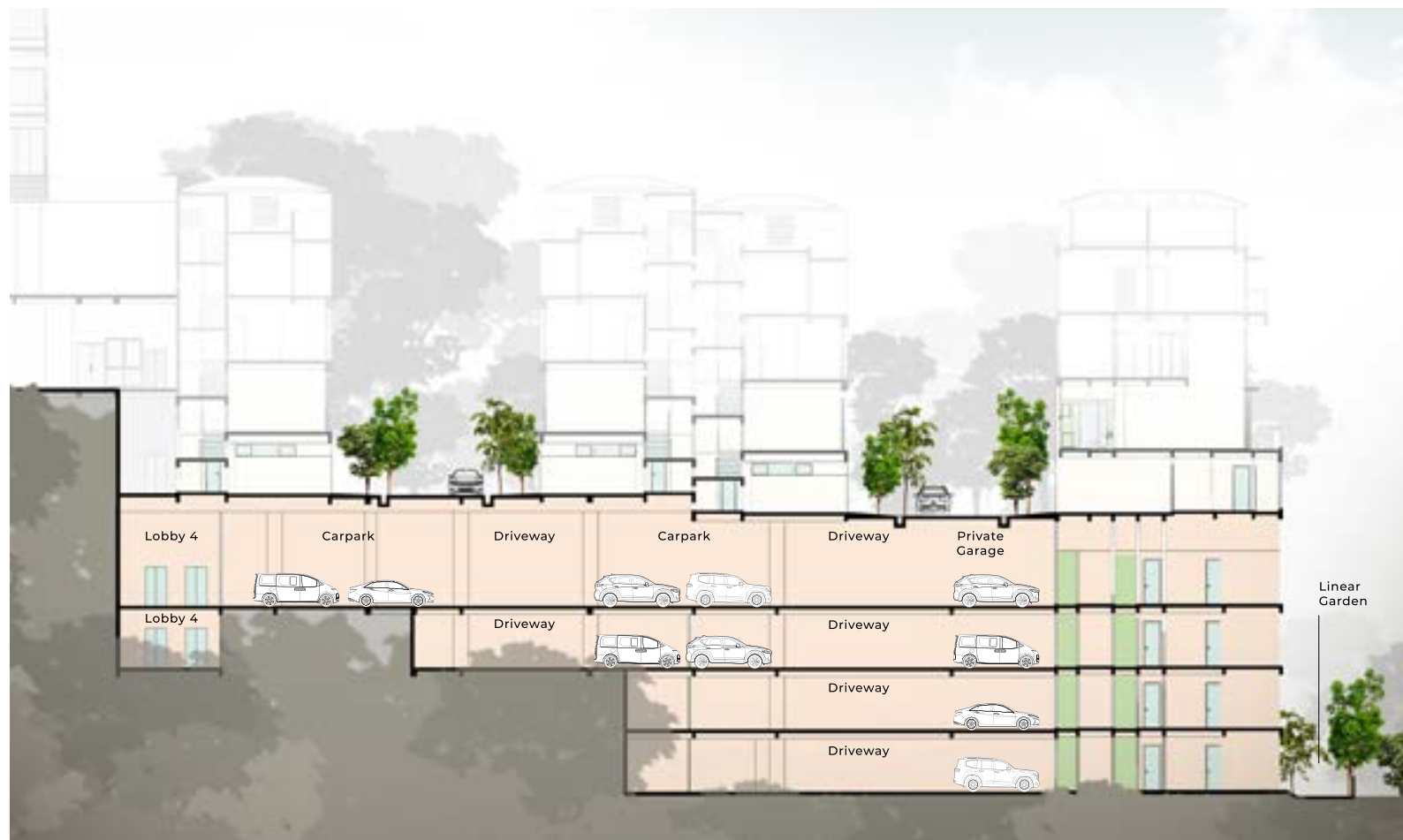

LEVEL A-1	A-1-10 Type A1	A-1-09 Type A	A-1-08 Type A	A-1-07 Type A	A-1-06 Type A	A-1-05 Type A	A-1-03A Type A		A-1-03 Type A	A-1-02 Type A	NURSERY						
LEVEL A-2	A-2-16 Type A1	A-2-15 Type A	A-2-13A Type A	A-2-13 Type A	A-2-12 Type A	A-2-11 Type A	A-2-10 Type A		A-2-09 Type A	A-2-08 Type A	A-2-07 Type A	A-2-06 Type A	A-2-05 Type A	A-2-03A Type A	A-2-03 Type A	A-2-02 Type A	A-2-01 Type A2
LEVEL A-3	A-3-16 Type A1	A-3-15 Type A	A-3-13A Type A	A-3-13 Type A	A-3-12 Type A	A-3-11 Type A	A-3-10 Type A		A-3-09 Type A	A-3-08 Type A	A-3-07 Type A	A-3-06 Type A	A-3-05 Type A	A-3-03A Type A	A-3-03 Type A	A-3-02 Type A	A-3-01 Type A2
LEVEL A-3A	A-3A-16 Type A4	A-3A-15 Type A3	A-3A-13A Type A3	A-3A-13 Type A3	A-3A-12 Type A3	A-3A-11 Type A3	A-3A-10 Type A3		A-3A-09 Type A3	A-3A-08 Type A3	A-3A-07 Type A3	A-3A-06 Type A3	A-3A-05 Type A3	A-3A-03A Type A3	A-3A-03 Type A3	A-3A-02 Type A3	A-3A-01 Type A5

LEGEND
■ Type A ■ Type A1 ■ Type A2 ■ Type A3 ■ Type A4 ■ Type A5



FLOOR PLAN



3+1 Bedrooms



5 Bathrooms



3 Car Parks



EV Charging Point

PARK HOMES 57 UNITS ONLY

Type	Main Parcel sq.ft.	Accessory Parcel sq.ft.	Gross Area sq.ft.
A / A1	1,550	764	2,314
A2	1,517	753	2,270
A3 / A4	1,550	764	2,314
A5	1,517	753	2,270



TYPE A

2,314 sq.ft.



TYPE A1

2,314 sq.ft.

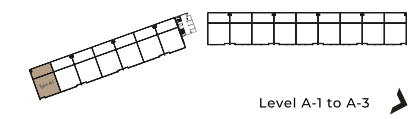

FLOOR PLAN



3+1 Bedrooms



5 Bathrooms



3 Car Parks



EV Charging Point

FLOOR PLAN



3+1 Bedrooms



5 Bathrooms



3 Car Parks



EV Charging Point

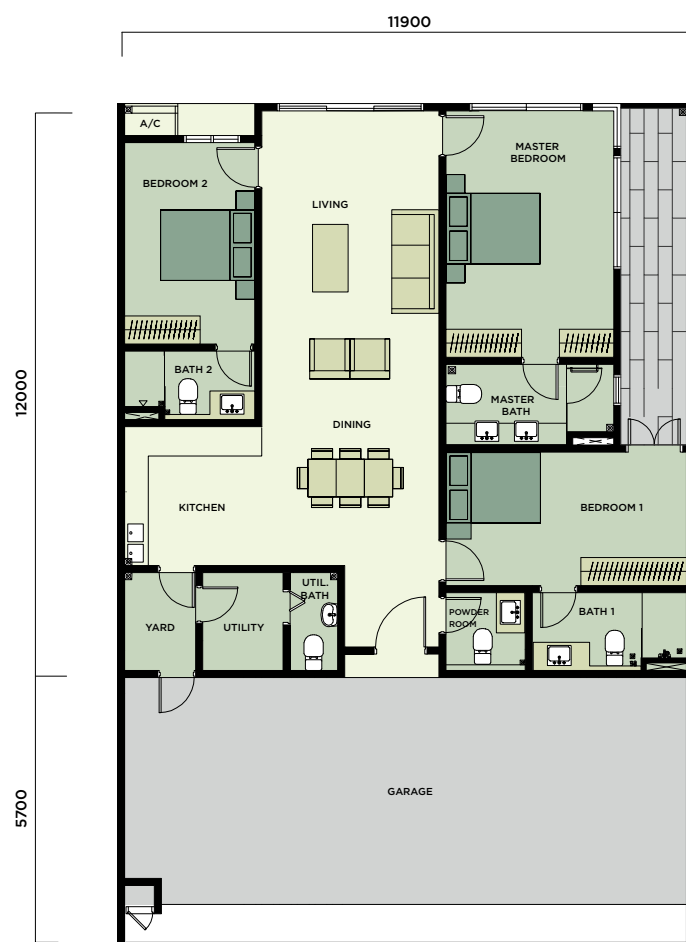

TYPE A2

2,270 sq.ft.

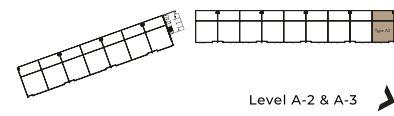

Level A-2 & A-3



TYPE A3

2,314 sq.ft.

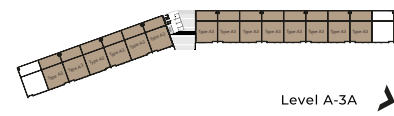

Level A-3A



TYPE A4

2,314 sq.ft.

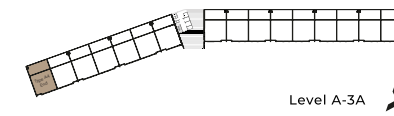

Level A-3A



TYPE A5

2,270 sq.ft.

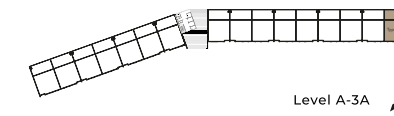

Level A-3A



PERFECTLY LOCATED

Nestled amidst some of KL's most sought-after neighbourhoods, Majestic @ Kiara Reserve offers unparalleled access to amenities and lush green surroundings. With seamless connectivity via major highways and proximity to vibrant retail, healthcare and educational hubs, every convenience is just minutes away.

CONVENIENT AMENITIES

Recreational

- Kuala Lumpur Golf & Country Club (KLGCC)
- Bukit Kiara Equestrian & Country Resort
- Kelab Golf Perkhidmatan Awam Malaysia (KGPA)

Wellbeing

- ParkCity Medical Centre
- KPJ Damansara Specialist Hospital
- UM Specialist Centre (UMSC)
- Pantai Hospital Kuala Lumpur

Education

- Garden International School
- Charterhouse International Secondary School
- Mont'Kiara International School
- Hevea French Primary School
- SMK Seri Hartamas

SEAMLESS ACCESSIBILITY

Direct Access Via

- Kerinchi Link
- DUKE Highway
- Penchala Link
- Damansara Link
- SPRINT Expressway
- Jalan Tuanku Abdul Halim

STRATEGIC NEIGHBOURHOODS

Within 2km

- Mont Kiara
- Sri Hartamas
- Bukit Damansara

Within 4km

- Taman Tun Dr Ismail
- Bangsar
- Damansara Heights
- Bukit Tunku

Within 10km

- Bandar Utama
- PJ Damansara
- KLCC

LOCATION MAP

A Coveted Address
In The Heart Of The City

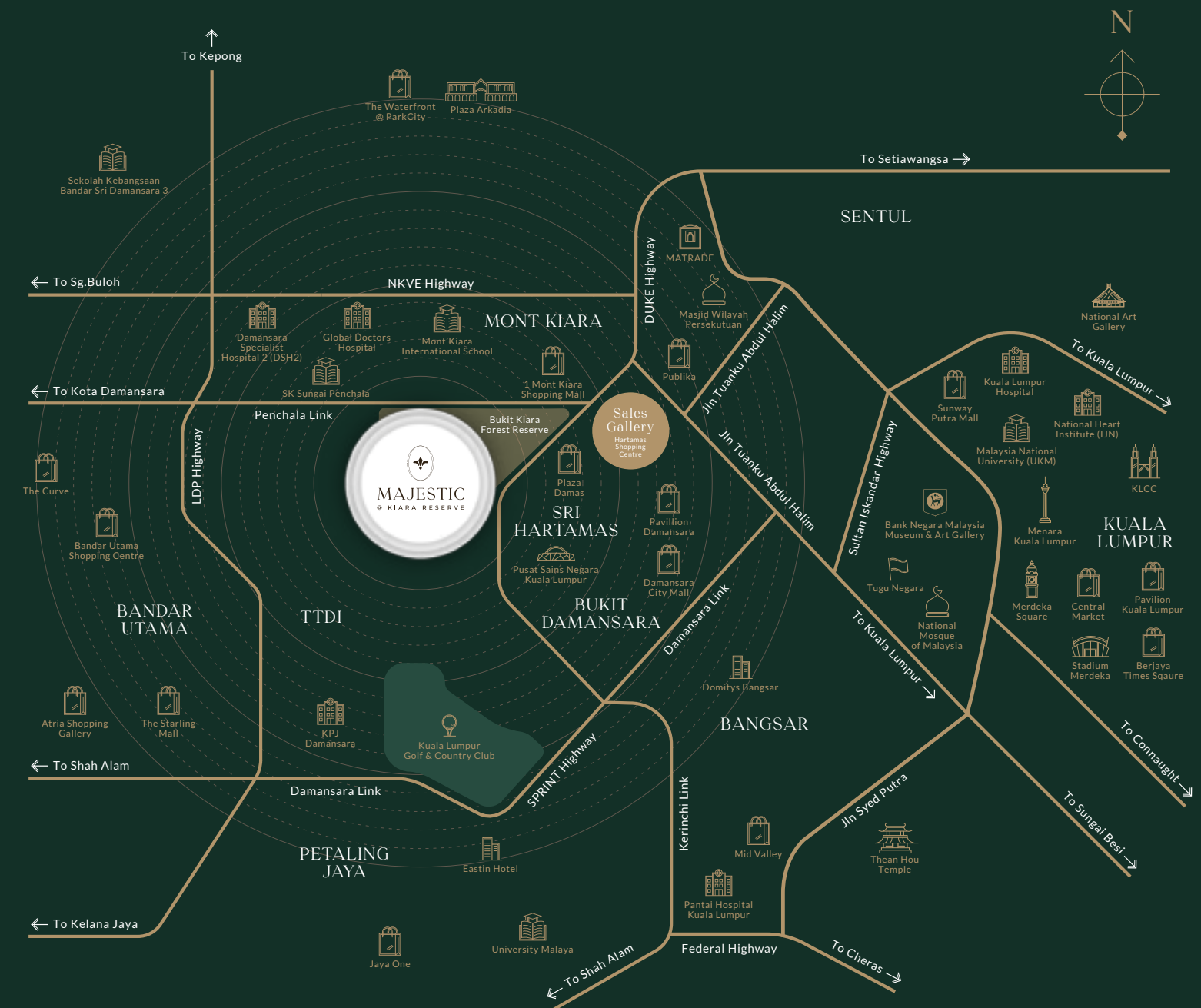



SPECIFICATIONS

Structure	: Reinforced Concrete	
Wall	: Reinforced Concrete / Brick Wall	
Roof	: Reinforced Concrete / Metal Deck Roof	
Ceiling	: Skim Coat and Paint / Plaster Ceiling	
Windows	: Powder Coat Aluminum Frame	
Doors	: Selected quality Timber Door / Aluminum Framed / Aluminum Framed Sliding	
Sanitary wares & Fittings	: Selected quality sanitary wares and fittings to all bathrooms (except utility's bathroom) : Double basins to master bathroom : Counter top to all bathrooms (except utility's bathroom)	
Ironmongery	: Digital Lockset / Quality Locksets	
Floor Finishes	: Garage	: Porcelain Tile
	: Foyer	: Marble Effect Porcelain Tiles
	: Living & Dining	: Marble Effect Porcelain Tiles
	: Kitchen	: Marble Effect Porcelain Tiles
	: Master Bedroom	: Engineered Hardwood Flooring
	: Bedroom 1 & Bedroom 2	: Engineered Hardwood Flooring
	: Powder Room	: Porcelain Tiles
	: Master Bath	: Porcelain Tiles
	: Bath 1 & Bath 2	: Porcelain Tiles
	: Yard / Wet	: Porcelain Tiles / Plaster & Paint (where applicable)
	: Utility	: Porcelain Tiles
	: Utility Bath	: Porcelain Tiles
	: Balcony	: Porcelain Tiles
Wall Finishes	: Garage	: Skim Coat & Paint / Plaster & Paint (where applicable)
	: Foyer	: Skim Coat & Paint / Plaster & Paint (where applicable)
	: Living & Dining	: Skim Coat & Paint / Plaster & Paint (where applicable)
	: Kitchen	: Porcelain Tile / Plaster & Paint (where applicable)
	: Master Bedroom	: Skim Coat & Paint / Plaster & Paint (where applicable)
	: Bedroom 1 & Bedroom 2	: Skim Coat & Paint / Plaster & Paint (where applicable)
	: Powder Room	: Porcelain Tiles
	: Master Bath	: Porcelain Tiles
	: Bath 1 & Bath 2	: Porcelain Tiles
	: Yard / Wet	: Porcelain Tiles
	: Utility	: Porcelain Tiles
	: Utility Bath	: Porcelain Tiles
	: Balcony	: Porcelain Tiles
Additional Features	: Air-conditioning wall-mounted units to living area, and all bedrooms (except utility room) : SMATV system : Fiber to the home (FTTH) infrastructure ready : 1-Phase Power Supply to all units : EV Charging point : Storage Water Heater to master bathroom, Bathroom 1 & 2 (except utility room) : Hot water mixer for master bathroom basin & shower : Water mixer for Bathroom 1 & 2 shower only : Shower screen with door to master bathrooms : Shower screen to all common bathrooms (except powder room and utility's bathrooms) : Instant water heater to utility's bathroom	



CRAFTSMANSHIP IN

DESIGN

This low-rise residence embodies refined simplicity, offering spacious, open-plan interiors filled with natural light. Each home includes three ensuite bedrooms, a private garage for three vehicles and an EV charging point. Large windows frame garden views, with selected units enjoying direct access to landscaped paths and green space. Designed for privacy, functionality and ease, Park Homes blends the tranquillity of landed living with the convenience of a premium Mont Kiara address.

AR. KAM KAH ZEN
ARCHITECT

Ar. Kam Kah Zen is an experienced architect and director at BEP Akitek Sdn Bhd with over 15 years in the industry. He holds degrees in Architecture and Landscape Architecture from University of Melbourne and is a registered member of APAM and LAM. He has led major residential and commercial projects like Ruma KL & Seni Mont Kiara



MR. THOTTHANET
LUEKIJNA
LANDSCAPE ARCHITECT

Thotthanet Luekijna, founder of XSITE Design Studio, is renowned for his ability to blend natural landscapes with modern architecture. His innovative designs, such as the Pollitan Aqua, showcase his expertise in integrating greenery and urban living. At Majestic @ Kiara Reserve, he brings his vision of creating tranquil, nature-inspired environments to life.



OUR
STORY

Mayland
Builder of Better Tomorrow

Since 1995, Mayland has been a pioneer in Malaysia's luxury real estate sector. With over 15,000 residences delivered, the group is renowned for creating "hospitality-inspired" living spaces that blend modern architectural design with the standards of world-class service.

Signature Portfolio

Mayland's track record includes some of Malaysia's most iconic addresses

.The Dorsett Series

Dorsett Residence Bukit Bintang, Dorsett Residence Sri Hartamas, Dorsett Waterfront Subang

.Notable Developments

Majestic @ Kiara Reserve, Royal Garden @ Jalan Kuching, and Hampton Damansara

.Innovation

Pioneers of "Seamless Premier Living" in Malaysia

Beyond the growth and success of Mayland in Malaysia, it is also a part of a sizeable international group of companies sharing the corporate lineage of the Hong Kong-based **Far East Organization (International) Limited**, a leading regional conglomerate specialising in property development and investment, hotel operations and management, car park operations and facilities management, securities and financial product investment and gaming operations in Mainland China, Hong Kong, Malaysia, Singapore, Australia, New Zealand, the United Kingdom and Continental Europe.



DEVELOPMENT BY

MAJESTIC LAND SDN BHD
6th Floor, Maytower (Menara May),
No.7, Jalan Munshi Abdullah,
50100 Kuala Lumpur

VISIT US

MAJESTIC @ KIARA RESERVE PROPERTY GALLERY
Lot F-02, First Floor, Hartamas Shopping Centre
No.60, Jalan Sri Hartamas 1, Sri Hartamas,
50480 Kuala Lumpur.

CONTACT US

www.majestickiara.com.my
☎ 015-4600 0886

